

# QUANTUM QSS2

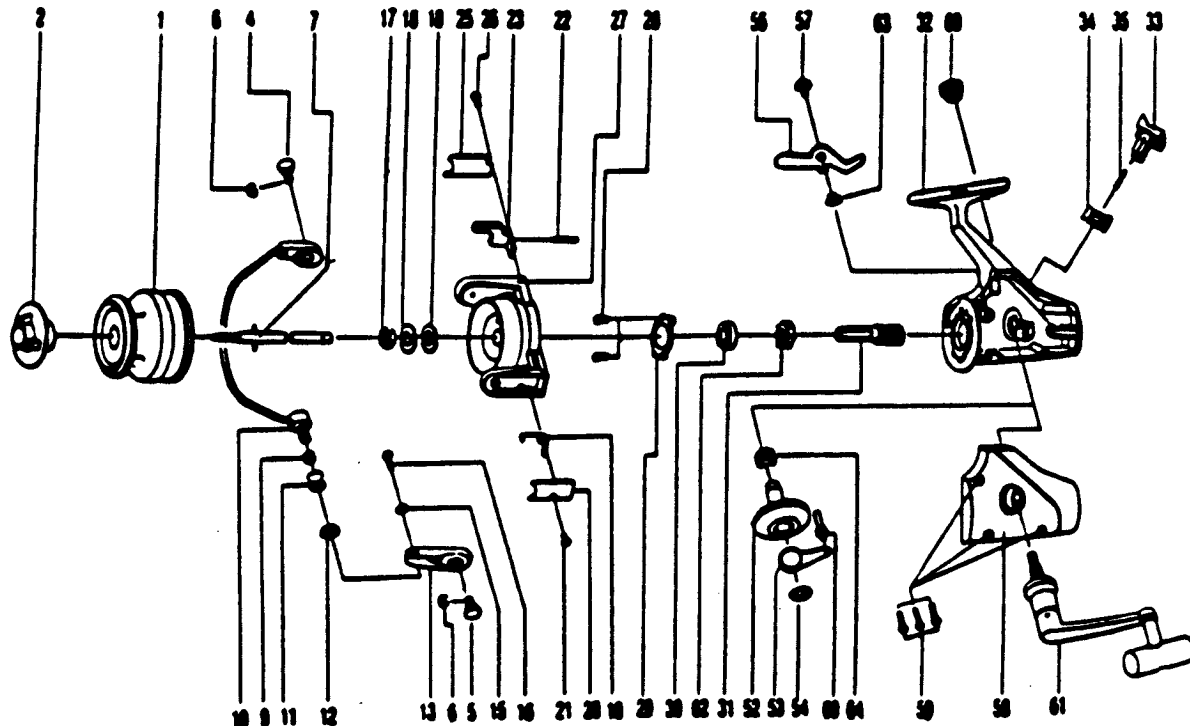

KEY PART NO. NO.	DESCRIPTION	PRICE	KEY PART NO. NO.	DESCRIPTION	PRICE
1 NS321	SPOOL ASSY.	6.31	28 NS080	BEARING PLATE SCREW	1.14
2 NS050	DRAG KNOB ASSY.	3.83	29 NS040	BEARING PLATE	1.27
4 NS044	BAIL HOLDER PIN	1.14	30 NS028	BALL BEARING	9.12
5 NS043	ARM LEVER PIN	1.32	31 NS011	PINION GEAR	3.39
6 NS002	E-CLIP	.29	32 NS301	BODY ASSY	9.12
7 NS315	MAIN SHAFT ASSY.	3.61	33 NS059	ANTI-REVERSE LEVER	.92
9 NS016	LINE ROLLER BUSHING	1.66	34 NS090	A/R LVR. PLATE SPR.	1.14
10 NS347	BAIL ARM ASSY.	4.02	35 NS091	A/R LVR. PIN	.46
11 NS004	LINE ROLLER	1.72	52 NS012	DRIVE GEAR	4.87
12 NS017	BAIL COLLAR	1.14	53 NS025	OSCILLATING SLIDER	2.98
13 NS007	ARM LEVER	1.14	54 NS026	DRIVE GEAR ADJ. WASHER	.46
15 NS102	BAIL WASHER	.29	56 NS063	ANTI-REVERSE CLAM	1.43
16 NS108	BAIL SCREW	.58	57 NS089	A/R CLAM SCREW	.29
17 NS006	ROTOR NUT	.92	58 NS323	BODY CVR. ASSY.	5.56
18 NS065	ROTOR RET. WASHER	.69	59 NS057	BODY COVER SCREW	.69
19 NS022	BAIL SPRING	.92	60 NS073	HANDLE SCRW CAP	1.14
20 NS087	BAIL SPRING COVER	1.03	61 NS318	HANDLE ASSY.	8.65
21 NS085	BAIL SPRING CVR SCR	.52	62 NS060	RATCHET GEAR	2.87
22 NS049	KICK LEVER SPRING	.39	63 NS014	A/R CLAM BUSHING	.92
23 NS019	KICK LEVER	1.61	64 NS066	SLIDER SPRING	.39
25 NS024	KICK LEVER COVER	.98	69 NS081	OSC. SLIDER PIN	2.09
26 NS037	KICK LVR CVR SCR	.52			
27 NS009	ROTOR	5.90			

Prices subject to change without notice. Prices do not include postage and handling.

**PLEASE ORDER BY PART NUMBER**

Rev. 11/90

Zebco Division Brunswick Corporation, Box 270, Tulsa, OK 74101 USA 618-638-6661

**BC**  
BRUNSWICK