

ZEBCO

BRUNSWICK CORPORATION
 CONSUMER DIVISION
 POST OFFICE BOX 270
 TULSA, OKLAHOMA 74101

ZEBCO PARTS LIST AND ORDER BLANK

MODEL SBL90 SPINNING REEL

PLEASE ORDER BY PART NUMBER, NOT KEY NUMBER.

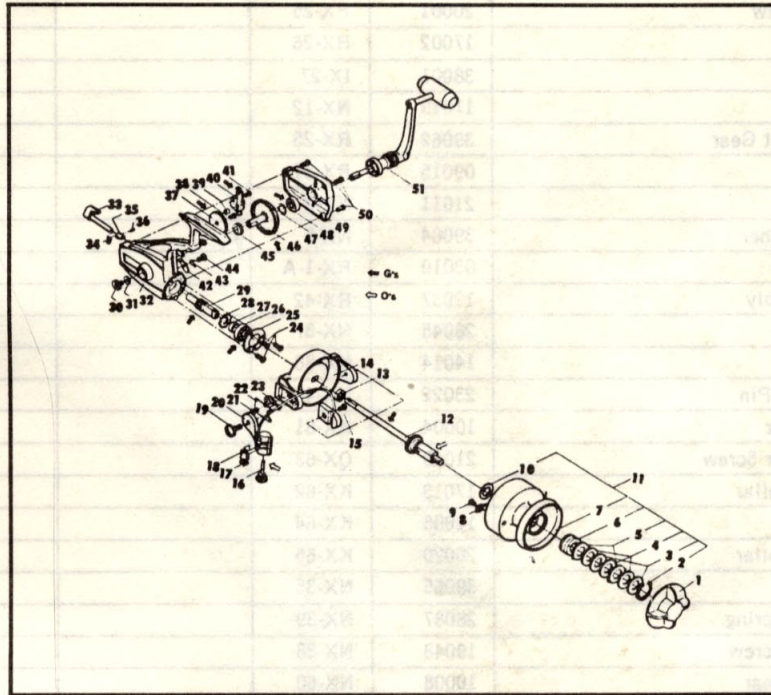

IF REQUIRED REPAIRS CANNOT BE MADE AT YOUR NEAREST FACTORY APPROVED SERVICE STATION, YOU MAY ORDER THE FOLLOWING REPLACEMENT PARTS DIRECT FROM THE FACTORY OR RETURN REEL TO FACTORY.

Your Order No. _____ Date _____
 Charge To _____ Ship To _____
 Address _____ Address _____
 City & State _____ City & State _____

DEFECTIVE PARTS REPLACED AT FACTORY ONLY

KEY NO.	DESCRIPTION	PART NUMBER		QUANTITY	PRICE	EXTENSION
		old	new			
1	Drag Knob Assembly	0232004	LX-32		\$1.25	✓
2	Drag Washer Retainer	39050	KX-28		.30	
3	Drag Washer A	26010A	KX-53		.20	
4	Drag Washer B	26012	KX-54		.30	
5	Drag Washer C	26011	KX-45		.35	
6	Drag Spring	28108	RX-30		.55	
7	Spool Assembly	06017A	RX-21		6.40	
8	Spool Click	39069	RX-33		.05	
9	Spool Click Screw	20016	RX-31		.10	
10	Click Washer	27040	RX-54		.10	
11	Spool Assembly	0206017A	RX-21		5.00	
12	Main Shaft Assembly	0212086	RX-15-A		2.90	
13	Rotor Nut	18001	HX-6		.15	
14	Rotor	05009A	RX-9-A		3.75	
15	Balance Weight Screw	21003	BX-47		.10	
16	Bail Arm Nut	19022	RX-19		.85	
17	Bail Arm Line Roller Washer	27032	NX-17	X'	.25	
18	Bail Arm Line Roller	25007	RX-4		1.55	

Canadian Prices 25% Higher