

# QUANTUM X3W

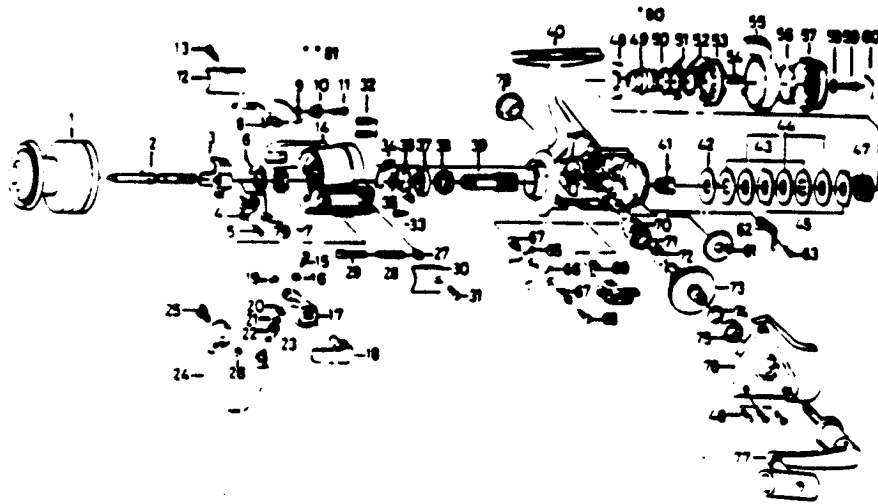

KEY PART NO.	DESCRIPTION	PRICE	KEY PART NO.	DESCRIPTION	PRICE
FK321-1	SPOOL (EXTRA)	6.31	43 MTO41	EARED WASHER	1.83
1 FK321	SPOOL (MAIN)	6.31	44 MTO46	DRAG WASHER C	1.83
2 MT315	MAIN SHAFT	3.16	45 MTO30	KEY WASHER	1.83
3 MTO25	OSCILLATING SLIDER	1.83	46 MTO57	SIDE COVER SCREW	2.87
4 MTO83	OSC. SLIDER RETAINER	.85	47 MTO31	DRAG COIL SPRING	1.27
5 MT161	OSC. SLIDER SCREW	.85	48 MT112	DRAG NUT A	3.39
6 MTO88	ROTOR NUT LOCK WASHER	1.27	49 MT121	DRAG SCREW	1.43
7 MTO06	ROTOR NUT	1.27	50 MT106	DRAG SCREW WASHER A	.98
8 GK019	BAIL TRIP LEVER	1.71	51 MT110	DRAG HOLDER	1.83
9 MTO49	BAIL TRIP LEVER SPRING	.85	52 MT111	DRAG SCREW WASHER B	.98
10 MT137	BAIL TRIP LV. BUSHING	.98	53 MT117	DRAG NUT B	4.53
11 MTO37	BAIL TRIP LEVER SCREW	.85	54 MT118	DRAG SPRING	1.09
12 MTO24	BAIL TRIP COVER	1.09	55 BK094	POWER LEVER	4.53
13 MTO85	BAIL SPG COVER SCRW	1.09	56 MTO95	POWER LEVER RETAINER	.46
14 FK009	ROTOR	4.87	57 MTO32	DRAG KNOB	3.39
15 MT108	RAIL SCREW	1.27	58 MT119	DRAG KNOB WASHER	.85
16 MT102	LOCK WASHER	.46	59 MTO79	DRAG KNOB SCREW	.85
17 MTO07	RAIL ARM	1.86	60 MT120	DRAG KNOB NAME PLATE	1.27
18 MT115	CAM CAST LEVER	5.68	61 MTO53	OSCILLATING GEAR	1.43
19 GK002	CAM CAST LEVER RET.	.46	62 MTO68	CLICK LEAF SPRING	.98
20 MTO17	LINE ROLLER COLLAR	.46	63 MTO67	CLICK LEAF SPRING SCRW	.85
21 MTO15	LINE ROLLER	.46	64 MTO14	ANTI-REV PAWL COLLAR	.98
22 MTO04	LINE ROLLER	1.72	65 MTO63	ANTI-REV. PAWL A	1.09
23 MTO16	LINE ROLLER BUSHING	.46	66 MTO64	ANTI-REV. PAWL B	1.27
24 MT347	BAIL	3.73	67 MTO61	ANTI-REV PAWL SPG A	.85
25 MTO44	BAIL HOLDER PIN	1.83	68 MTO69	ANTI-REV PAWL SCREW	.85
26 MTO03	BAIL TRIP CAM RET.	.88	69 MTO59	ANTI-REV. LEVER	1.27
27 MTO20	BAIL SPG SHAFT ELDR	.98	70 MTO52	BUSHING	2.24
28 MTO22	BAIL SPRING	.46	71 MT253	OSCILLATING PW GEAR	1.66
29 MTO29	BAIL SPRING SHAFT	1.09	72 MTO66	ANTI-REV PAWL SPG B	.98
30 MTO87	BAIL SPRING COVER	.98	73 BK012	DRIVE GEAR	5.68
31 MTO85	BAIL SPG COVER SCRW	1.09	74 MTO26	DRIVE GEAR WASHER	.46
32 MTO80	BEARING RET. SCREW A	.98	75 MT157	BALL BEARING	9.12
33 MTO93	BEARING RET. SCREW B	.98	76 BK323	SIDE COVER	5.68
34 MTO82	BAIL TRIP PLATE	1.43	77 BK318	HANDLE ASBY.	11.46
35 MTO27	FINION WASHER	.85	78 MTO73	HANDLE SCREW CAP	2.30
36 MTO40	BEARING RETAINER	1.72	79 MTO58	RTR NUT LOCK SCREW	.85
37 MTO28	BALL BEARING	9.12	80 MT121	DRAG SCREW	1.43
38 MTO60	ANTI-REV. RATCHET	3.35	81 MT122	BAIL TRIP LEVER WEHR	.46
39 BK011	FINION GEAR	6.59			
40 BK301	BODY	9.12			
41 MTO66	CLICK GEAR	1.83			
42 MTO39	DRAG WASHER B	1.66			

\*Not pictured  
Located between keys 48 & 80

\*\*Not pictured  
Located between keys 10 & 11

Prices subject to change without notice. Prices do not include postage and handling.

**PLEASE ORDER BY PART NUMBER**

Rev. 11/80

Zabco Division Brunswick Corporation, Box 278, Tada, OK 74101 USA 918-688-8871

