



BRUNSWICK CORPORATION
CONSUMER DIVISION
 POST OFFICE BOX 270,
 TULSA, OKLAHOMA 74101

ZEBCO PARTS LIST AND ORDER BLANK

MODEL XB75 SPINNING REEL

PLEASE ORDER BY PART NUMBER, NOT KEY NUMBER

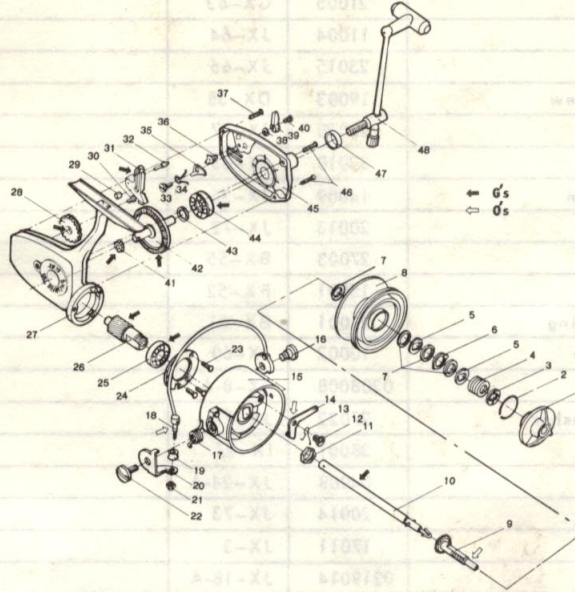

IF REQUIRED REPAIRS CANNOT BE MADE AT YOUR NEAREST FACTORY APPROVED SERVICE STATION, YOU MAY ORDER THE FOLLOWING REPLACEMENT PARTS DIRECT FROM THE FACTORY OR RETURN REEL TO FACTORY.

Your Order No. _____ Date _____

Charge To _____ Ship To _____

Address _____ Address _____

City & State _____ City & State _____

DEFECTIVE PARTS REPLACED AT FACTORY ONLY

KEY NO.	DESCRIPTION	PART NO.		QUANTITY	PRICE	EXTENSION
		OLD	NEW			
1	Drag Knob	0232001	HX-32		\$.85	
2	Drag Washer Retainer	28004	EX-28		.10	
3	Drag Washer A	26005A	JX-35		.20	
4	Spring Washer	28029	JX-30		.30	
5	Drag Washer A	26005	JX-68		.30	
6	Drag Washer B	26006	HX-49		.15	
7	Drag Washer C	27001	EX-45		.15	
8	Spool Assembly	0206011	JX-21		2.40	
9	Spool Click	0213007	JX-33		.95	
10	Main Shaft Assembly	0212017	JX-15-A		1.50	
11	Rotor Nut	18001	HX-6		.15	
12	Bail Arm Lever Screw	19003	BX-41		.20	
13	Bail Arm Lever Spring	28001	HX-42		.15	
14	Bail Arm Lever	15002	HX-43		.20	
15	Rotor	05001	HX-9-1		2.05	
16	Bail Arm Cam B Screw	19002	HX-14		.30	
17	Bail Arm Spring	28006	HX-45		.15	
18	Bail Arm Assembly With Cam B	0229001	HX-10-A		1.75	
19	Bail Arm Line Roller	25001	CX-4		.35	
20	Bail Arm Cam A	15008	JX-7		.50	
21	Bail Arm Nut	18006	JX-19		.35	
22	Bail Arm Cam A Screw	19001	HX-16		.55	
23	Ball Bearing Holding Screw	20001	JX-25-1		.10	

(Continued on Reverse Side)