



BRUNSWICK CORPORATION
CONSUMER DIVISION
 POST OFFICE BOX 270,
 TULSA, OKLAHOMA 74101

ZEBCO PARTS LIST AND ORDER BLANK

MODEL XB85 SPINNING REEL

PLEASE ORDER BY PART NUMBER, NOT KEY NUMBER

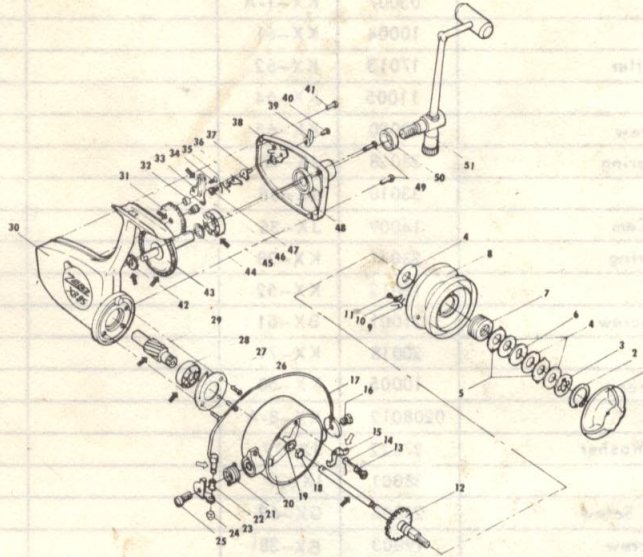

IF REQUIRED REPAIRS CANNOT BE MADE AT YOUR NEAREST FACTORY APPROVED SERVICE STATION, YOU MAY ORDER THE FOLLOWING REPLACEMENT PARTS DIRECT FROM THE FACTORY OR RETURN REEL TO FACTORY.

Your Order No. _____ Date _____
 Charge To _____ Ship To _____
 Address _____ Address _____
 City & State _____ City & State _____

DEFECTIVE PARTS REPLACED AT FACTORY ONLY

KEY NO.	DESCRIPTION	PART NO.		QUANTITY	PRICE	EXTENSION
		OLD	NEW			
1	Drag Knob Assembly	0232005	KX-32		\$1.10	
2	Drag Washer Retainer	39050	KX-28		.30	
3	Drag Washer A	26010A	KX-53		.20	
4	Drag Washer B	26012	KX-54		.30	
5	Drag Washer C	26011	KX-45		.35	
6	Drag Washer D	26010	KX-68		.20	
7	Spring Washer	28035	KX-30		.35	
8	Spool	06014	KX-21		4.73	
9	Spool Click Spring	28038	KX-34		.15	
10	Spool Click	33009	KX-33		.15	
11	Spool Click Screw	19019	KX-31		.15	
12	Main Shaft Assembly	0212024	KX-15-A		2.00	
13	Bail Arm Lever Screw	19003	BX-48		.20	
14	Bail Arm Lever Spring	28039	KX-42		.15	
15	Bail Arm Lever	15013	KX-43		.30	
16	Bail Arm Cam B Screw	19024	KX-14		.50	
17	Bail Arm Assembly W/Cam B	0229006	KX-10-A		1.85	
18	Rotor Nut	18001	HX-6		.15	
19	Lock Washer	27068	KX-5		.05	
20	Rotor	05006	KX-9-A		2.50	
21	Bail Arm Spring	28036	KX-49		.30	
22	Bail Line Roller	25004	KX-4		.35	
23	Bail Arm Cam A	15010	KX-7		.50	
24	Bail Arm Nut	18006	JX-19		.35	

(Continued on Reverse Side)