

ZEBCO

BRUNSWICK CORPORATION
 CONSUMER DIVISION
 POST OFFICE BOX 270
 TULSA, OKLAHOMA 74101

ZEBCO PARTS LIST AND ORDER BLANK

MODEL XBL77 SPINNING REEL

PLEASE ORDER BY PART NUMBER, NOT KEY NUMBER.

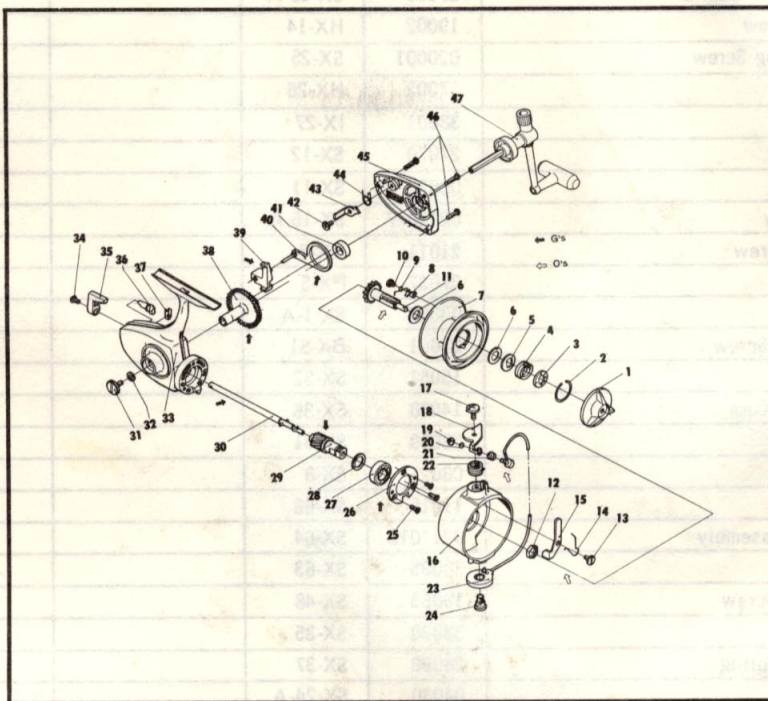

IF REQUIRED REPAIRS CANNOT BE MADE AT YOUR NEAREST FACTORY APPROVED SERVICE STATION, YOU MAY ORDER THE FOLLOWING REPLACEMENT PARTS DIRECT FROM THE FACTORY OR RETURN REEL TO FACTORY.

Your Order No. _____ Date _____

Charge To _____ Ship To _____

Address _____ Address _____

City & State _____ City & State _____

DEFECTIVE PARTS REPLACED AT FACTORY ONLY

KEY NO.	DESCRIPTION	PART NUMBER		QUANTITY	PRICE	EXTENSION
		old	new			
1	Drag Knob	32001	SX-32		\$1.50	
2	Stopper Spring	28004	EX-28		.10	
3	Drag Washer A	26001A	EX-53		.15	
4	Spool Spring	28007	EX-30		.30	
5	Drag Washer B	26001	EX-54		.15	
6	Drag Washer C	27001	EX-45		.10	
7	Spool Assembly	0206001	HX-21		4.24	
8	Click	33027	HX-40		.15	
9	Click Spring	28083	HX-34		.15	
10	Click Screw	19054	HX-31		.10	
11	Spool Click Assembly	0213007	JX-33		.95	
12	Rotor Nut	18001	HX-6		.15	
13	Bail Arm Folding Lever Screw	19003	BX-48		.20	
14	Bail Arm Lever Spring	28096	SX-42		.20	
15	Bail Arm Lever	15059	SX-7		.65	
16	Rotor	05024	SX-9		4.60	
17	Bail Arm Cam A Screw	19001	HX-16		.55	
18	Bail Arm Lever	15058	SX-43		.70	

Canadian Prices 25% Higher