

**BRUNSWICK CORPORATION**  
**CONSUMER DIVISION**  
 POST OFFICE BOX 270,  
 TULSA, OKLAHOMA 74101

## ZEBCO PARTS LIST AND ORDER BLANK MODEL XR10 SPINNING REEL

PLEASE ORDER BY PART NUMBER, NOT KEY NUMBER

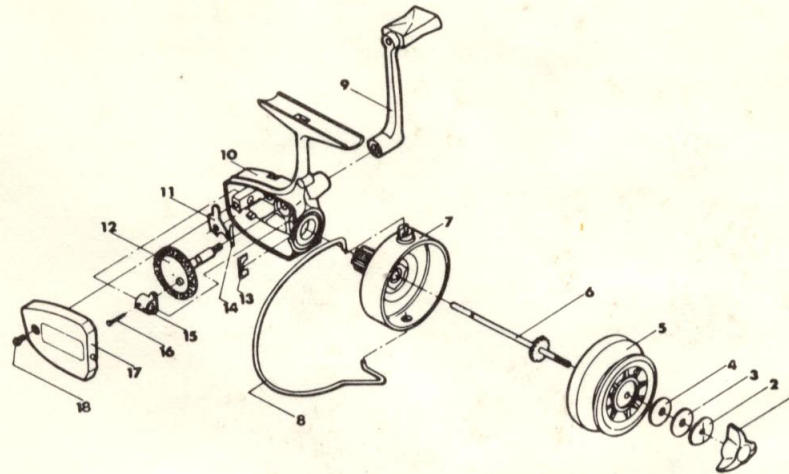

IF REQUIRED REPAIRS CANNOT BE MADE AT YOUR NEAREST FACTORY APPROVED SERVICE STATION, YOU MAY ORDER THE FOLLOWING REPLACEMENT PARTS DIRECT FROM THE FACTORY OR RETURN REEL TO FACTORY.

Your Order No. \_\_\_\_\_ Date \_\_\_\_\_  
 Charge To \_\_\_\_\_ Ship To \_\_\_\_\_  
 Address \_\_\_\_\_ Address \_\_\_\_\_  
 City & State \_\_\_\_\_ City & State \_\_\_\_\_

### DEFECTIVE PARTS REPLACED AT FACTORY ONLY

KEY NO.	DESCRIPTION	PART NO.		QUANTITY	PRICE	EXTENSION
		OLD	NEW			
1	Drag Knob	32002	AX-32		\$ .20	
2	Spring Washer	27015	AX-28		.10	
3	Metal Washer	27014	AX-53		.10	
4	Felt Washer	26002	AX-30		.10	
5	Spool Assembly	0206005	AX-21		.49	
6	Main Shaft Assembly	0212012	AX-15-A		.30	
7	Rotor Assembly	0205002	AX-9-A		.70	
8	Bail Arm	29002	AX-10		.30	
9	Handle Assembly	0207005	AX-18-A		.55	
10	Main Body	03003	AX-1-A		.70	
11	Anti-Reverse Claw	33005	AX-35		.20	
12	Main Gear Assembly	08005	AX-8-A		.35	
13	Roto Retainer	30002	AX-14		.10	
14	Anti-Reverse Spring	28022	AX-37		.10	
15	Oscillating Slider	11002	AX-64		.20	
16	Oscillating Slider Pin	23010	AX-66		.10	
17	Side Plate	04005	AX-24		.20	
18	Side Plate Screw	20011	AX-73		.10	

Amount \_\_\_\_\_

Less \_\_\_\_\_

**POSTAGE PREPAID**

Please send this Amount \_\_\_\_\_