



BRUNSWICK CORPORATION
CONSUMER DIVISION
 POST OFFICE BOX 270,
 TULSA, OKLAHOMA 74101

ZEBCO PARTS LIST AND ORDER BLANK

MODEL XR20 SPINNING REEL

PLEASE ORDER BY PART NUMBER, NOT KEY NUMBER

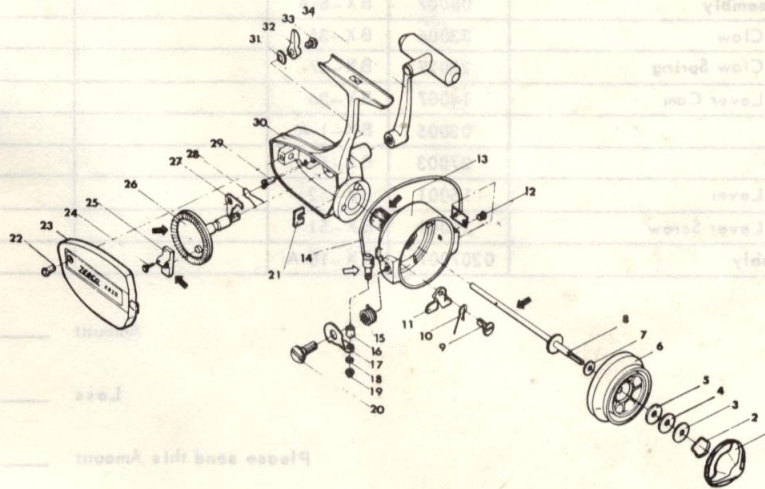

IF REQUIRED REPAIRS CANNOT BE MADE AT YOUR NEAREST FACTORY APPROVED SERVICE STATION, YOU MAY ORDER THE FOLLOWING REPLACEMENT PARTS DIRECT FROM THE FACTORY OR RETURN REEL TO FACTORY.

Your Order No. _____ Date _____

Charge To _____ Ship To _____

Address _____ Address _____

City & State _____ City & State _____

DEFECTIVE PARTS REPLACED AT FACTORY ONLY

KEY NO.	DESCRIPTION	PART NO.		QUANTITY	PRICE	EXTENSION
		OLD	NEW			
1	Drag Knob	32003	BX-32		\$.30	
2	Drag Washer Retainer	28023	BX-28		.10	
3	Metal Washer A	26003	BX-53		.10	
4	Felt Washer B	27045	BX-30		.10	
5	Rubber Washer C	26004	BX-54		.10	
6	Spool Assembly	0206009	BX-21		1.50	
7	Spool Washer	27019	BX-45		.10	
8	Main Shaft Assembly	0212014	BX-15-A		.70	
9	Bail Arm Lever Screw	19003	BX-48		.20*	
10	Bail Arm Lever Spring	28024	BX-42		.20	
11	Bail Arm Lever	15007	BX-43		.20	
12	Bail Arm Seat Screw	21003	BX-47		.10	
13	Rotor Assembly w/Pinion Gear	0205004	BX-9-A		2.05	
14	Bail Arm Assembly	0229004	BX-10		1.10	

(Continued on Reverse Side)