

**BRUNSWICK CORPORATION**  
**CONSUMER DIVISION**  
 POST OFFICE BOX 270,  
 TULSA, OKLAHOMA 74101

# ZEBCO PARTS LIST AND ORDER BLANK

## MODEL XRL15 SPINNING REEL

PLEASE ORDER BY PART NUMBER, NOT KEY NUMBER

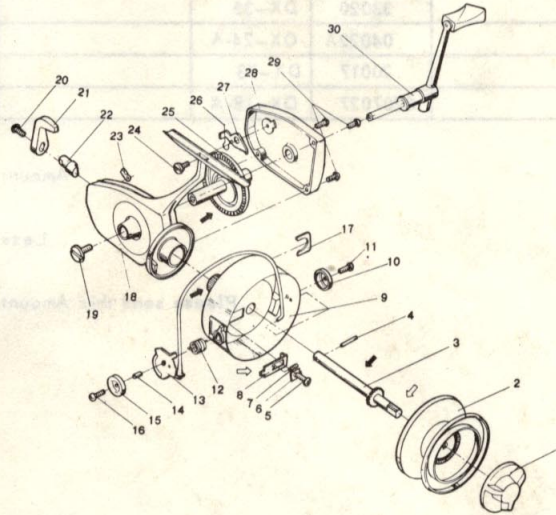

IF REQUIRED REPAIRS CANNOT BE MADE AT YOUR NEAREST FACTORY APPROVED SERVICE STATION, YOU MAY ORDER THE FOLLOWING REPLACEMENT PARTS DIRECT FROM THE FACTORY OR RETURN REEL TO FACTORY.

Your Order No. \_\_\_\_\_ Date \_\_\_\_\_  
 Charge To \_\_\_\_\_ Ship To \_\_\_\_\_  
 Address \_\_\_\_\_ Address \_\_\_\_\_  
 City & State \_\_\_\_\_ City & State \_\_\_\_\_

### DEFECTIVE PARTS REPLACED AT FACTORY ONLY

KEY NO.	DESCRIPTION	PART NO.		QUANTITY	PRICE	EXTENSION
		OLD	NEW			
1	Drag Knob	32016	OX-32		\$ .15	✓
2	Spool Assembly	0206025	OX-21		1.39	
3	Main Shaft	0212061	OX-15-A		.70	✓ ✓
4	Oscillating Pin	23035	OX-66		.10	✓
5	Bail Arm Lever Screw	21001	BX-51		.10	✓
6	Lever Washer	39057	OX-46		.15	
7	Lever Spring	28085	OX-42		.20	
8	Bail Arm Lever	15037	OX-43		.20	✓
9	Rotor	05014	OX-9-A		2.05	
10	Bail Arm Holder	27064	OX-12		.25	
11	Bail Arm Holder Screw	20011	AX-73		.10	
12	Bail Arm Spring	28084	OX-49		.15	
13	Bail Arm Assembly	0229016	OX-10-A		.50	✓
14	Bail Arm Assembly Collar	17010	JX-62		.35	✓
15	Bail Arm Holder	27064	OX-12		.25	
16	Bail Arm Holder Screw	20011	AX-73		.10	✓
17	Rotor Retainer	30007	DX-17		.10	
18	Main Body	03018	OX-1-A		1.80	
19	Handle Retainer Screw	19050	FX-3		.15	
20	Anti-Reverse Lever Screw	21001	BX-51		.10	✓

(Continued on Reverse Side)