

IF REQUIRED REPAIRS CANNOT BE MADE AT YOUR NEAREST FACTORY APPROVED SERVICE STATION, YOU MAY ORDER THE FOLLOWING REPLACEMENT PARTS DIRECT FROM THE FACTORY OR RETURN REEL TO FACTORY.

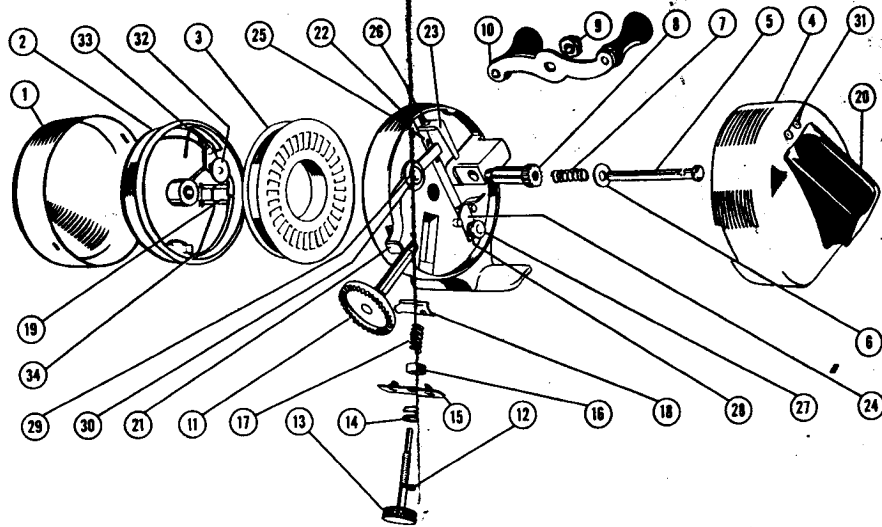

Reference Number	Description	Part Number
1	Front Cover Assembly	OZ-24-AB
2	Spinner Head Ass'y.	OZ-10-A
3	Spool	OZ-21
4	Back Cover Assembly	OZ-23-AB
5	Control Pin	OZ-15
6	Control Pin Washer	OZ-22
7	Control Pin Spring	OZ-20
8	Pinion Gear	OZ-11
9	Crank Nut	BZ-3
10	Crank Handle Ass'y.	BZ-18-A
11	Crank Shaft Ass'y.	OZ-8-A
12	Retainer Pin	OZ-29
13	Adjustment Screw	OZ-32
14	Cover Lock Spring	OZ-55
15	Cover Lock	OZ-56
16	Adjustment Screw Nut	OZ-36
17	Adj. Screw Spring	OZ-39

Reference Number	Description	Part Number
18	Brake Shoe	OZ-52
19	Pick up Pin Assembly	OZ-6-A
20	Thumb Brake Assembly	OZ-9-A
21	Click Actuator	OZ-2
22	Body Sub Assembly	OZ-1-A
23	Click Spring	OZ-14
24	Anti-Reverse Pawl	OZ-63
25	Click Bar	OZ-48-A
26	Click Rivet	LZ-72
27	Click Washer	OZ-25
28	Anti-Reverse Spring	OZ-70
29	Tension Washer	OZ-57
30	Click Washer	OZ-25
31	Thumb Brake Rivet	OZ-64
32	Brake Stud Washer	OZ-30
33	Line Brake Assembly	OZ-53-A
34	Pick up Pin Spring	OZ-49

DRAG ADJUSTMENT

The ZEBCO spinning reel, Model 66, is equipped with an adjustable drag to protect the line from breakage by large fish or snags. The drag adjustment screw (13) located at the lower left side of the reel, can be adjusted for any weight line. To tighten or loosen drag adjustment, turn "ON" or "OFF" in direction of arrow on the head. The extreme "ON" position will completely lock the spool.

SALT WATER USE

Though your ZEBCO spinning reel is

primarily designed for fresh water use, its parts have been completely anodized and plated to resist corrosion. However, to assure continued reliable performance, AFTER FISHING IN SALT OR BRACKISH WATER, RINSE IN FRESH WATER, DRY, CLEAN, AND RE-LUBRICATE.

ANTI-REVERSE MECHANISM

Your Model 66 ZEBCO utilizes a 3-position anti-reverse mechanism. Center position of the click actuator (21) permits the crank handle to rotate forward or backward freely. Upper position of the click actuator engages the click spring,