

ZEBCO PARTS LIST AND ORDER BLANK
MODEL 870 AND 874 SPINATOR SPINNING REEL

Canadian Prices 25% Higher

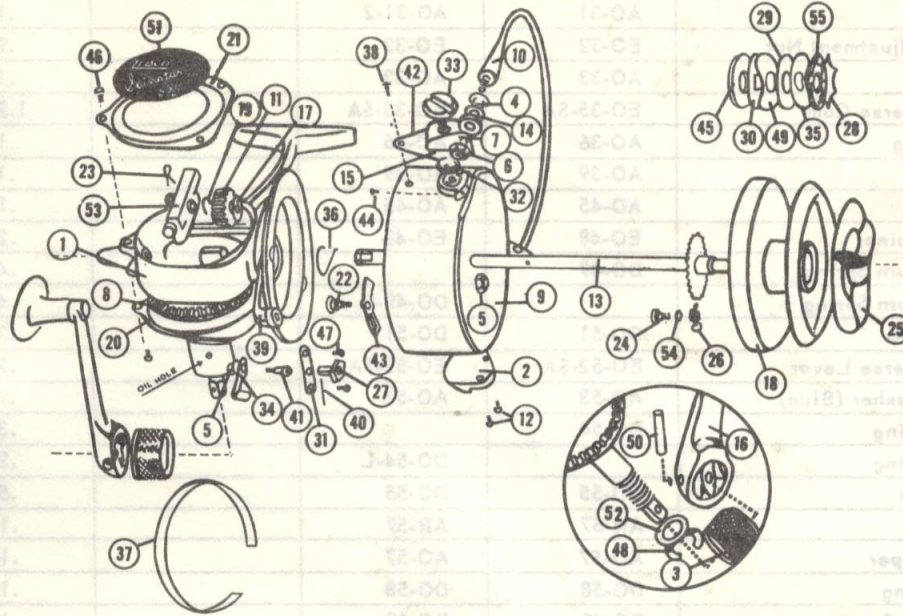

IF REQUIRED REPAIRS CANNOT BE MADE AT YOUR NEAREST FACTORY APPROVED SERVICE STATION, YOU MAY ORDER THE FOLLOWING REPLACEMENT PARTS DIRECT FROM THE FACTORY OR RETURN REEL TO FACTORY.

Your Order No. _____ Date _____
 Charge To _____ Ship To _____
 Address _____ Address _____
 City & State _____ City & State _____

DEFECTIVE PARTS REPLACED AT FACTORY ONLY

REF. NO.	DESCRIPTION	LEFT RETRIEVE 870 PART NO.	RIGHT RETRIEVE 874 PART NO.	QUANTITY	PRICE	EXTENSION
1	Body Assembly	EO-1-SA	EO-1-SA		\$5.20	
2	Counter Weight	DO-2-1	DO-2-1		.35	
3	Crank Nut	DO-3	DO-3		.90	
4	Line Roller	DO-4	DO-4		.55	
5	Nut (2)	AO-6	AO-6		.25	
6	Bail Nut	DO-6	DO-6		.40	
7	Bail Bracket Assembly	DO-7-SA			.75	
7	Bail Bracket Assembly		DO-7-SA-L		.75	
8	Crank Shaft	DO-8-1-SA	DO-8-1-SA		4.25	
9	Cowl	EO-9	EO-9		3.50	
10	Bail Assembly	EO-10-1-SA	EO-10-1-SA		2.00	
11	Pinion Gear	AO-11	AO-11		.50	
12	Bail Retainer Screw	AO-14-F	AO-14-F		.05	
13	Center Shaft Assembly	EO-15-SA	EO-15-SA		1.50	
14	Bail Roller Retainer	DO-16	DO-16		.25	
15	Bail Bracket Adj. Screw	DO-17	DO-17		.25	
16	Crank Handle	EO-18-SA	EO-18-SA		1.90	
17	Pinion Washer	BO-19	BO-19		.10	
18	Spool (Inc. Brake)	EO-21-SA			5.25	
18	Spool (Inc. Brake)		EO-21-SA-L		5.25	
19	Pinion Retainer	DO-22	DO-22		.15	
20	Crank Shaft Cover	DO-23-1-SA	DO-23-1-SA		1.50	
21	Name Plate Cover	DO-24-1-SA	DO-24-1-SA		1.00	

(Continued on Reverse Side)