

**ZEBCO**

# STERLING™ 40SR™

## CLOSED-FACE SPINNING REEL

weight	3.7 oz/105 g		
pound test	4	6	8
yards	88	60	48
meters	78	55	41
gear ratio	4:1:1		

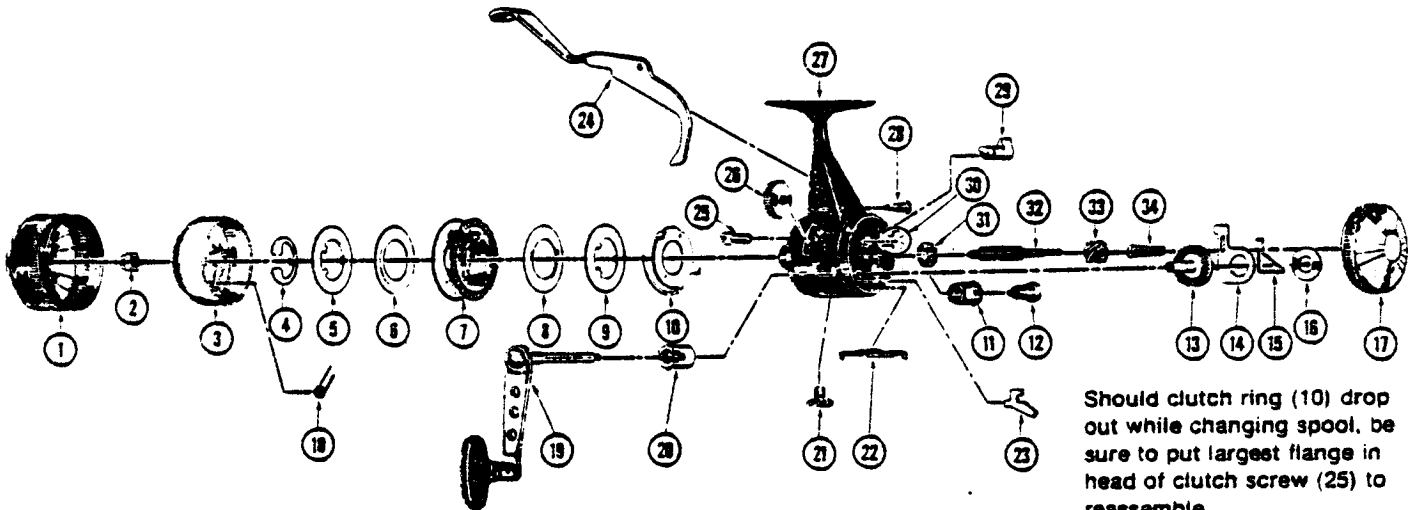

Should clutch ring (10) drop out while changing spool, be sure to put largest flange in head of clutch screw (25) to reassemble.

### MODEL 40SR

Key No.	Part No.	Description	Key No.	Part No.	Description
1	BJ324-4	Front Cover (Sterling)	18	AJ049	Spinner Head Spring
2	AJ006	Spinner Head Nut	19	BJ318-3	Handle Assy. (SR)
3	AJ310	Spinner Head Assy.	20	BJ026	Crank Bearing
4	XZ034	Spool Clip	21	AJ055	Cover Lock Screw
5	BJ040	Spool Washer	22	BJ056	Cover Lock Nut
6	BJ108	Flat Washer	23	BJ060	Anti-Reverse Pawl
7	AJ021	Spool (Empty)	24	BJ050	Finger Brake
	AJ321-6T	Spool w/6# Trilene	25	BJ054	Clutch Screw
8	BJ108	Flat Washer	26	BJ032	Clutch Wheel
9	BJ040	Spool Washer	27	BJ301-3	Body (SR) w/Bearing
10	BJ027	Clutch Ring	28	BJ126	Finger Brake Screw
11	BJ026	Crank Bearing	29	BJ002	Anti-Reverse Actuator
12	BJ069	Crank Rod Nut	30	BJ121	Retainer Clip
13	BJ012	Crank Gear	31	BJ017	Center Shaft Bearing
14	BJ014	Anti-Reverse Drag	32	BJ015	*Center Shaft
15	BJ061	Anti-Rev. Pawl Spring	33	BJ011	*Pinion Gear
16	BJ106	Thrust Washer	34	BJ020	*Center Shaft Spring
17	BJ023-4	Back Cover (Sterling)			

\*Available as One Unit,  
BJ315 Center Shaft Assy.

PLEASE ORDER BY PART NUMBER

Zebco Division Brunswick Corporation, Sox 270, Tulsa, OK 74101 USA 918-836-5581

**BC**  
BRUNSWICK