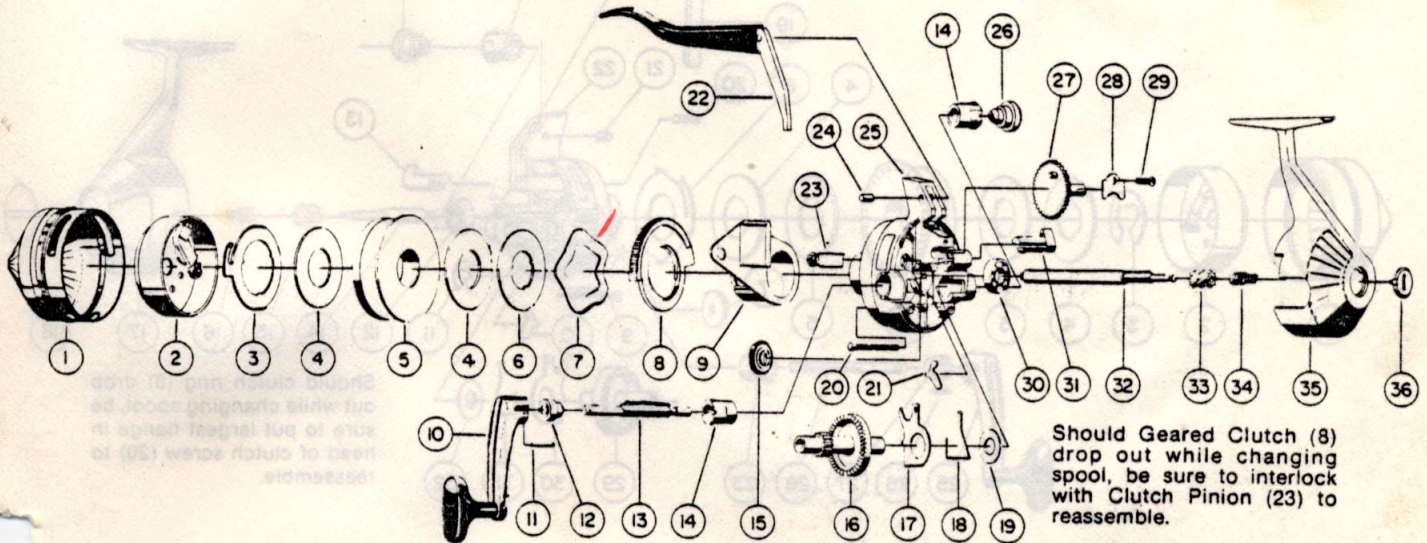

**ZEBCO**

# STERLING™ 60SR™

## CLOSED-FACE SPINNING REEL

weight	15.5 oz./440 g		
pound test	12	14	17
yards	180	165	125
meters	165	151	114
gear ratio	3.5:1		

**MODEL 60SR**

Key No.	Part No.	Description
1	DJ324-1	Front Cover Assy. (SR)
2	DJ310	Spinner Head Assy.
3	DJ034	Spool Clip
4	DJ108	Flat Washer
5	DJ021	Spool (Empty)
	DJ321-17T	Spool w/17# Trilene
6	DJ040	Spool Washer
7	DJ027	Clutch Ring
8	DJ197	Geared Clutch
9	DJ189	Spool Carrier
10	DJ318-2	Crank Handle (SR/11-13)
11	CJ171	Crank Handle Pin
12	DJ068	Crank Handle Spacer
13	DJ067	Crank Rod
14	CJ026	Crank Bearing
15	DJ032	Clutch Wheel
16	DJ012	Crank Gear
17	CJ014	Anti-Reverse Drag
18	CJ061	Anti-Rev. Pawl Spring

Key No.	Part No.	Description
19	CJ106	Pawl Spring Washer
20	CJ126	Machine Screw
21	CJ060	Anti-Reverse Pawl
22	DJ350	Finger Brake Assy.
23	DJ054	Clutch Pinion
24	CJ172	Finger Brake Pin
25	DJ301-3	Body Assy. (SR)w/Bearing
26	DJ769-2	Crank Rod Nut (SR)
27	DJ190	Oscillator Gear
28	DJ199	Oscillator Gear Ret.
29	AJ057	Retainer Screw
30	AZ028	Ball Bearing
31	DJ002	Anti-Rev. Actuator
32	DJ015	*Center Shaft
33	CJ011	*Pinion Gear
34	DJ020	*Center Shaft Spring
35	DJ023	Back Cover Assy.
36	DJ075	Back Cap

\*Available As One Unit,  
DJ315 Center Shaft Assy.

PLEASE ORDER BY PART NUMBER