

QUANTUM QD310

DISCONTINUED

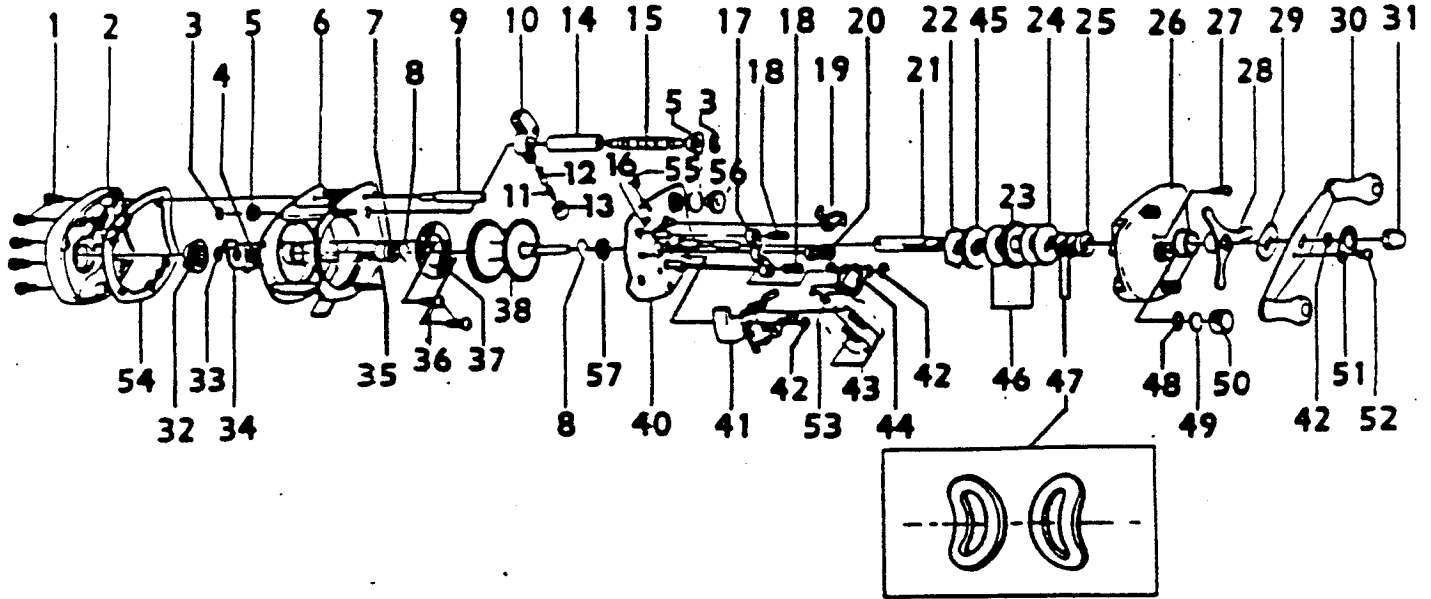

Key No.	Part No.	Description	Price	Key No.	Part No.	Description	Price
	CX4000	SPARE PARTS W/WRENCH	3.69	31	CX4702	HANDLE NUT	.91
1	CX4102	LEFT SIDE PLATE SCREW	.36	32	CX4303	MAGNETIC CONTROL DIAL	.99
2	CX4101	LEFT SIDE PLATE	5.21	33	CX4250	O RING	.49
3	CX4152	WORM SHAFT RETAINER	.31	34	CX4261	MAGNET RET. SUPPORT	1.46
4	CX4301	MAGNET RET. SPRING	.36	35	CX4255	SPOOL TENSION SHIM A	.36
5	CX4156	WORM GUARD BUSHING	.62	36	CX4602	MAGNET RETAINER SCREW	.62
6	CX4051	FRAME	20.88	37	CX4257	MAGNET RETAINER	8.59
7	BX4156	SPOOL SHAFT BUSHING	2.69	38	CX4251	SPOOL ASSY	13.35
8	CX4253	BEARING RETAINER	.36	39	CX4260	U SPOOL CONVERTER	3.07
9	BX4159	FRAME POST- SILVER	1.53	40	CX4351	SET PLATE ASSY	16.58
10	CX4201	LINE GUIDE	4.00	41	CX4402	SPOOL RELEASE BUTTON	2.00
11	CX4203	LINE GUIDE PAWL SPRING	.36	42	CX4656	RETAINER CLIP	.36
12	CX4202	LINE GUIDE PAWL	2.21	43	CX4353	SET PLATE ACT. SPRING	.36
13	CX4204	PAWL CAP	.91	44	CX4503	SET PLATE ACTUATOR B	.91
14	BX4158	WORM SHFT GUARD-SILVER	2.64	45	CX4658	BASE DRAG WASHER	.36
15	CX4151-1	WORM SHAFT W/O GEAR	3.69	46	CX4661	DRAG WASHER A	.36
16	CX4502	SPOOL RELEASE SPRING	.36	47	CX4662	DRIVE SHAFT SPR. WSHR	.36
17	CX4401	PINION YOKE	.62	48	CX4258	O RING	.36
18	CX4403	PINION-YOKE SPRING	.36	49	CX4302	SPOOL TENSION SHIM B	.36
19	CX4452	ANTI-REV. PAWL	.91	50	CX4259	SPOOL TENSION KNOB	1.84
20	NX4256	PINION GEAR	9.21	51	CX4703	HANDLE NUT LOCK	.62
21	CX4652	DRIVE SHAFT	3.69	52	CX4704	HANDLE NUT LOCK SCREW	.36
22	CX4451	ANTI-REV. RATCHET	2.64	53	CX4501	SET PLATE ACT. A	.36
23	NX4651	DRIVE GEAR	6.14	54	BX4107	LEFT PLATE SPACER-RED	1.53
24	CX4659	DRAG WASHER B	.62	55	CX4153	GEAR RETAINING CLIP	.31
25	CX4254	DRIVE SHFT BUSH	.62	56	NX4150	WORM SHAFT GEAR	4.31
26	BX4103	RIGHT SIDE PLATE	11.47	57	BX4157	SPOOL SHAFT BUSHING B	2.69
27	CX4352	RIGHT SIDE COVER SCREW	.36				
28	CX4663	STAR DRAG	4.90				
29	CX4660	HANDLE WASHER	.36				
30	CX4701	HANDLE	5.53				

Prices subject to change without notice. Prices do not include postage and handling. Some parts may not be available.

PLEASE ORDER BY PART NUMBER

Rev. 5/93

Zebco Division Brunswick Corporation, Box 270, Tulsa, OK 74101 USA 918-836-5581

